

# INSTALLATION GUIDE – Luna TWPC 26x140

	<p>2,5 kpl/m 2,5 pcs/m</p> <p>Fastclip</p>	<p>140 mm</p> <p>26 mm</p> <p>6,85 jm/m<sup>2</sup> 6,85 rm/m<sup>2</sup></p>	
<p>Power drill</p>	<p>Plastic glue</p>	<p>RUOSTUMATON ROSTFREIER STAINLESS INOXYDABLE ROSTFRI</p> <p>4 – 4,2 × 35 – 45 mm ← Ø max 8 mm</p> <p>Screw</p>	<p>Rubber-hammer</p>

## 1 PERUSTA / SUPPORTING STRUCTURE

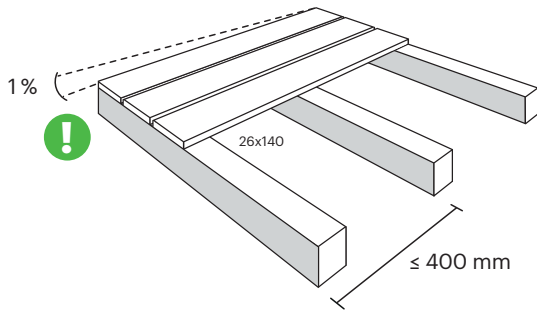

## 2 ALOITUS / TO START

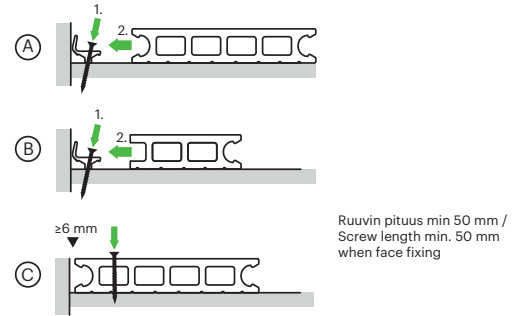

## 3 KIINNITYS / FASTENING

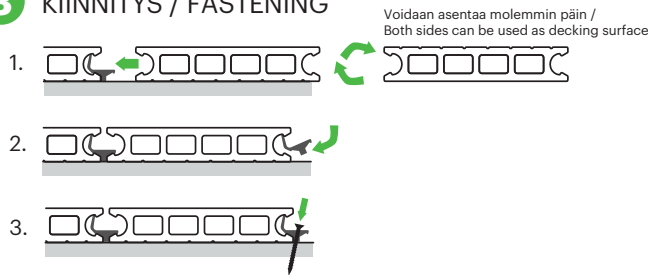

## 4 LAUDAN JATKAMINEN / END TO END JUNCTION

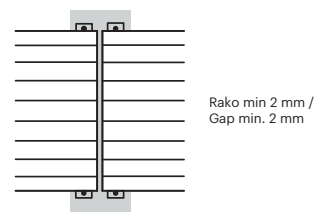

## 5 REUNALISTA / SIDE STRIP

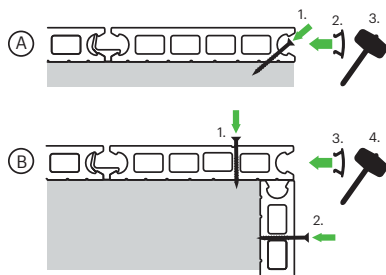

## 6 VIIMEISTELY / FINALIZING

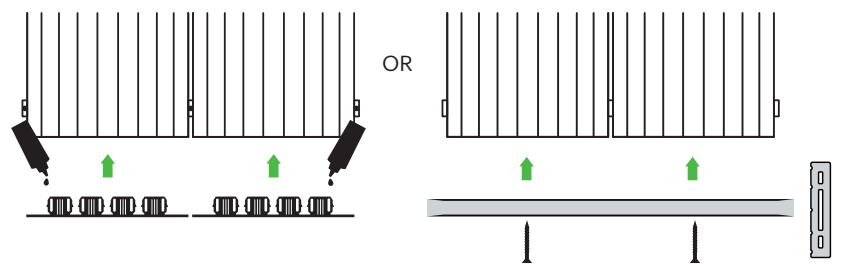

## KULMALISTA / ANGLE FRAME

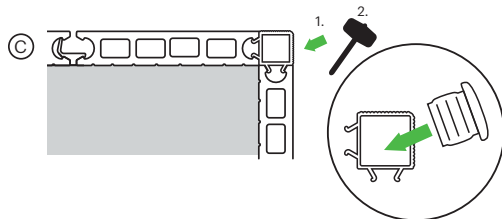

## 7 SAUMANAUHA / GAP STRIP (lisävaruste / optional)

