



Himmelbyen, 2017-2019. Architect: The Seasons.
Photo: Terkel Bo Grum-Schwensen. ©Bergsten Timber AS

Fire protected Lunawood ThermoWood®

Lunawood ThermoWood® products are available also as fire protected. This expands the possibilities of using Lunawood in sustainable architecture even further. Using the impregnation method, Lunawood ThermoWood® meets the required fire class B for the facade structures.

The use of Lunawood in versatile projects with fire class requirements is subject to Euro code EN 13501. Using the impregnation method, Lunawood Thermowood meets the required fire class B of the facade structures.

The used technology and method for fire protection is a documented, CE-marked treatment process which enables a consistent quality of fire protection. Planed, flat tongue&groove Lunawood products achieve the fire class B-s1,d0, where as 3D-Lunawood products are tested to fire class B-s2,d0. For outdoor use the requirement for Reaction to fire is min. B-s2,d0. For indoor use it is B-s1,d0.

The same visual appearance with improved fire class

Throughout impregnated fire protection does affect on neither the visual appearance nor the original technical properties of Lunawood. The treatment is durable in all climates. Lunawood offers also painted fire protected products conducted by CE-certified painter Partner.

Good to know

- Euroclass B-s1/s2,d0 (EN 13501)
- Original product properties preserved
- No leaching, no need for maintenance
- Also available factory-painted conducted by CE-certified painter Partner





Structural requirements

The substrate needs to meet fire classification of A1 or A2, whereas support battens are of wood in fire class D or of aluminium. The cladding ought to meet fire classification of B.

Ventilation gap in closed structures, i.e., for tongue&groove products according to Lunawood installation guide for facades. Open constructions need to be tested and approved separately.

Product	Fire class	Usage	Note
Flat, min. 19 mm thick tongue&groove Lunawood Thermowood of Nordic Spruce and Pine	B-s1,d0	Outdoor and indoor use	
3D-look spruce products	B-s2,d0	Outdoor use	Only vertical installation
Battens	B-s1,d0	Outdoor and indoor use	Needs to be fire tested as a whole structure

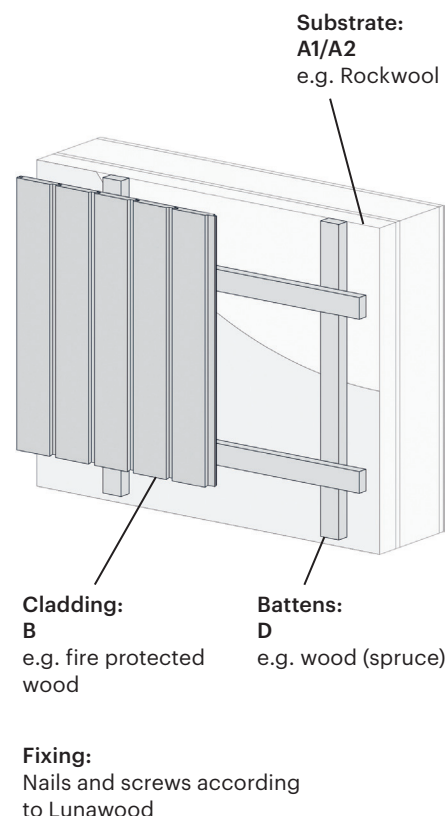

lunawood.com

This document is provided for information purposes only. No liability or responsibility of any kind is accepted by Lunawood or their representatives, although Lunawood has used reasonable efforts to verify the accuracy of any advice, recommendation, or information. Lunawood reserves the right to alteration of its products, product information and product range without any notice.